



# CLASSIC 18

COOLING CAPACITY	BTU/Hr. @ 95°F at 60% Relative Humidity		18,000
DIMENSIONS	Width (Inches)		19.3
	Depth (Inches)		26.4
	Height (Inches)		41
	Weight (Pounds)		167
	Shipping Weight (Pounds)		200
ELECTRICAL CHARACTERISTICS	Power Supply (Volts)		208/230V 1 Phase
	Power Consumption (Kilowatts)		2.1
	Current Consumption (Amperes)		10.8
	Fuse Size (Amperes)		15
	NEMA Plug Configuration		6-15
	Minimum-Maximum Voltage		195-250 Volt
	Power Cord	Gauge	14 (3 wire)
	Length (Feet)	6	
COMPRESSOR CHARACTERISTICS	Compressor Type		Hermetic Rotary
	R 22 Charge (Pounds)		1.59
	Operating Conditions Minimum-Maximum °F		68°-105°F, 50% RH
FAN CHARACTERISTICS	Evaporator	Fan Type	Centrifugal
		Air Flow (Cubic Feet/Minute)	530
		Maximum External Static (Inches of Water Gauge)	.52
	Condenser	Fan Type	Centrifugal
		Air Flow (Cubic Feet/Minute)	1177
		Maximum External Static (Inches of Water Gauge)	.25
SAFETY DEVICES	Compressor Overload Relay		Yes
	Fan Motor Protection		Yes
	Anti-Freeze Thermostat		Yes
	Automatic Tank Shut-off		Yes
	Condensate Tank Capacity (Gallons)		5.3
	High-Pressure Switch		No
	Compressor Short-Cycle Protection		Yes
	Fan Mode Switch		No
	Automatic Restart		Yes
	Thermostat		Yes
MISCELLANEOUS FEATURES	Operating Cost (Approximate Per Hour)		\$.15
	Humidity Removed @ 60% RH (Gallons/Hour)		.9
	Accommodates Condensate Pump		Yes
	Sound Level (db)		63
	Maximum Evaporator Ducting Length* (Feet)		50
	Maximum Condenser Ducting Length* (Feet)		60
	* Subtract 10 Feet for every 90° bend		

# CLASSIC 18

POWER SUPPLY	208/230 VOLTS 60 HERTZ 1 PHASE 10.8 AMPERES	
HEIGHT	41 INCHES W/CASTERS	<p>All models are backed by a 12-month warranty with 36 months for the compressor.</p> <p>All coils are treated with an acrylic resin coating for extended life and corrosion resistance.</p>
WIDTH	19.3 INCHES	
DEPTH	26.4 INCHES	
HEIGHT	37.5 INCHES W/O CASTERS	
WEIGHT	167 LBS	

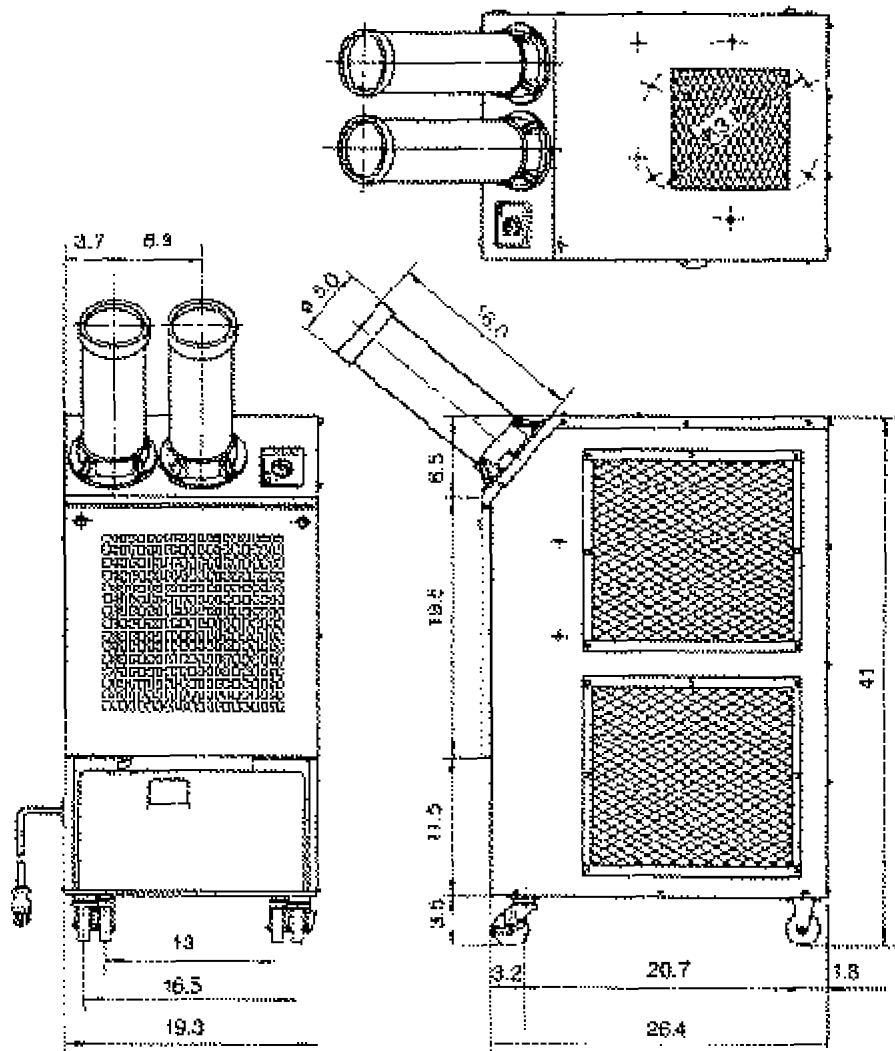

# CLASSIC 18

## ACCESSORIES

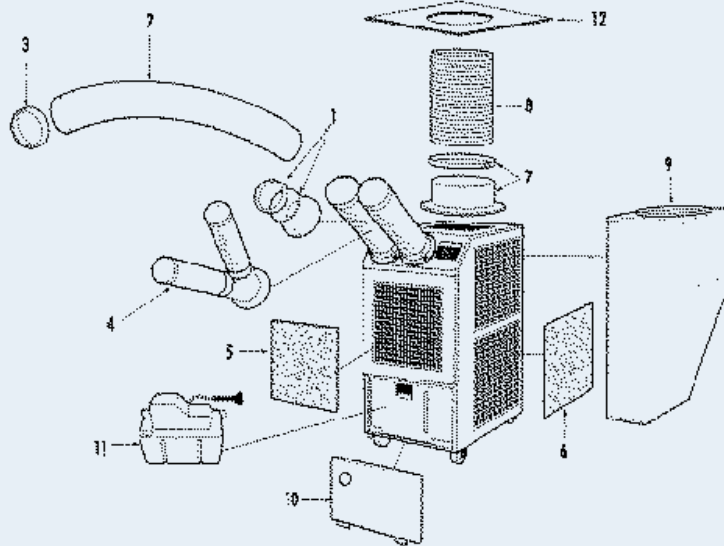

NO.	PART NAME	DESCRIPTION	PART NUMBER
1	Cold Air Flange and Clamp	5" diameter	481170-0180
2	Cold Air Extension Duct	5" diameter x 10' length	481744-0090
3	Cold Air Duct Trim Ring	5" diameter	481851-0200
4	Dual Duct	5" diameter flange with two 4" ducts	484209-0030
5	Evaporator Filter Element	15" x 15" x 1/2" (13 PPI standard)	484401-0230
		15" x 15" x 1/2" (30 PPI industrial)	484401-0260
6	Condenser Filter Element	15" x 15" x 1/2" (13 PPI standard)	484401-0230
		15" x 15" x 1/2" (30 PPI industrial)	484401-0260
7	Warm Air Flange and Clamp	12" diameter	481170-0190
8	Warm Air Duct	12" diameter x 10' length	481744-0060
9	Air Plenum Kit	Return condenser air	LA-146499-1400
10	Cover Plate	To cover condensate collection area	484009-0480
11	Condensate Pump Kit	220V	CPK1
12	Ceiling Tile	24" x 24" tile with 12" flange for exhaust duct	LA-146373-8280

# CLASSIC 18

## CONSTRUCTION DIAGRAM

All models are backed by a 12-month warranty with 36 months for the compressor.  
 All coils are treated with an acrylic resin coating for extended life and corrosion resistance.

